

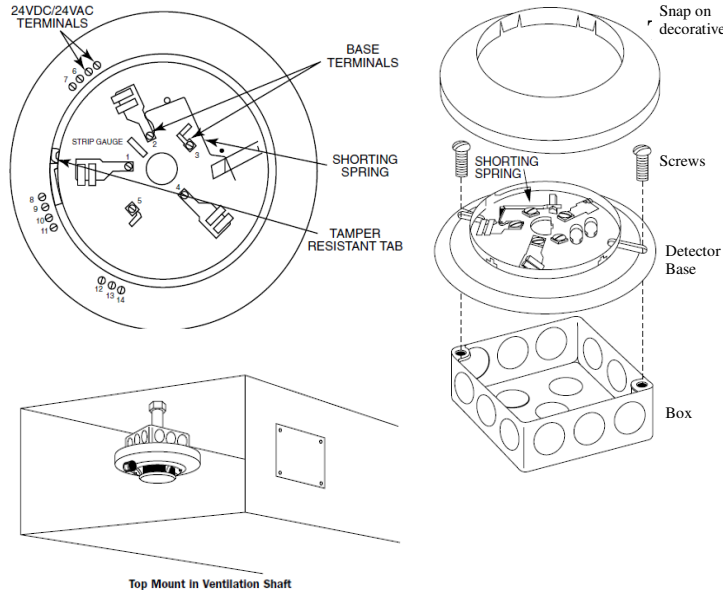

FIRE SMOKE DAMPER WITH SMOKE DETECTOR

B114LP PLUG-IN DETECTOR



MODELS:
FSD/CFSD/SD

DESCRIPTION

The model B114LP detector base is designed for use with System Sensor model 2151 photoelectronic and 1151 ionization detector heads. This four-wire base is equipped with screw terminals for the connection of power, ground, relay connections, and an optional RA400Z/RA100Z remote annunciator. It also includes a resistor that limits current when the associated smoke detector is in the alarm state.

SMOKE DETECTOR OVERVIEW

- Low-profile smoke detector design
- Low standby current
- Two LEDs "blink" in standby
- Detector head plugs easily into base
- Built-in test switch
- Built-in tamper-resistant feature
- Field sensitivity metering of detector to meet the requirements of NFPA 72
- 120VAC and 24VAC/DC bases with built-in shorting spring
- Designed for mounting on standard electrical box
- SEMS screws for easy wiring and positive wire retention
- Removable cover and insect screen for field cleaning

WIRING DIAGRAM

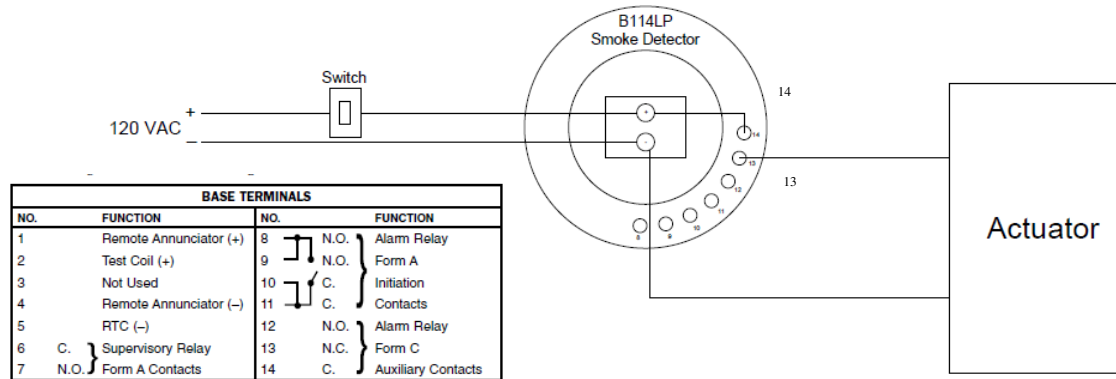

SPECIFICATIONS

Base Diameter: 6.2 in (157 mm)
 Base Height: 0.95 in (24 mm)
 Weight: 0.6 lb (274 g)
 Mounting: 4" square box with or without plaster ring, minimum depth 1.5"; 4" octagon box, minimum depth 1.5"; 3½" octagon box, minimum depth 1.5"; 3½" octagon box, minimum depth 1.5"
 Operating Temperature Range: 0°C to 49°C (32°F to 120°F)
 Operating Humidity Range: 10% to 93% Relative Humidity Non-condensing

Electrical Ratings (includes base and detector)

System Voltage: 120 VAC, 60 Hz
 Relay Contact Ratings Resistive Load: Form A — 2.0A @ 30VAC/DC; Form C — 2.0A @ 30VAC/DC, 1.0A @ 125VAC
 (If used, the RA400 Remote Annunciator and RTC operates within the specified detector system voltage)
 Start-up Time (after 60 second reset): 36.0 seconds maximum

